

Drei Mal am Tag*

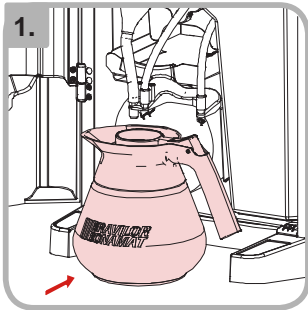

- Leere Kanne aufstellen

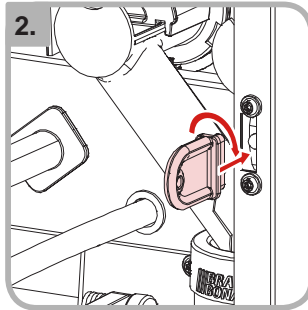

- Kundendienstschlüssel.

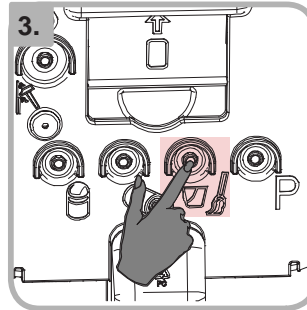

- Spültaste drücken.

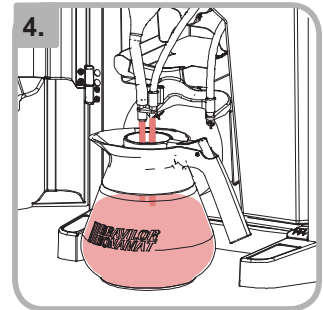

- Spülprogramm ist in Betrieb

Täglich

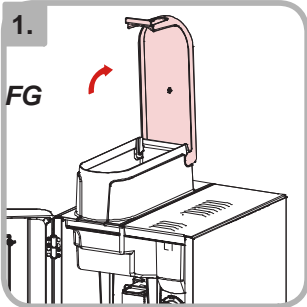

- Tür und Deckel öffnen

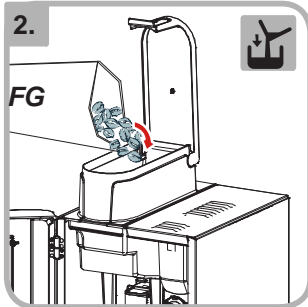

- Kaffeebohnen nachfüllen

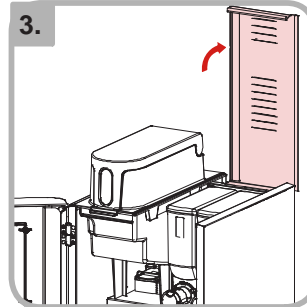

- Tür und Deckel öffnen

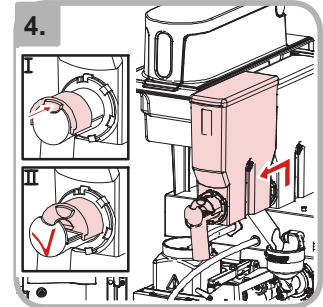

- Behälterauslauf schließen und Behälter entfernen

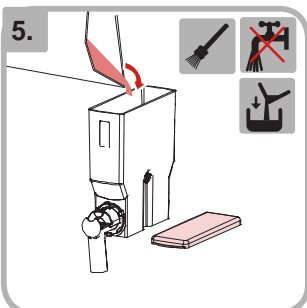

- Produkt nachfüllen

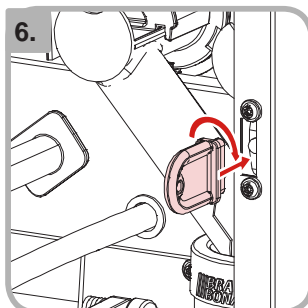

- Kundendienstschlüssel.

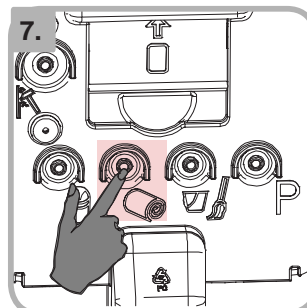

- Taste Öffnen/Schließen der Brühinheit

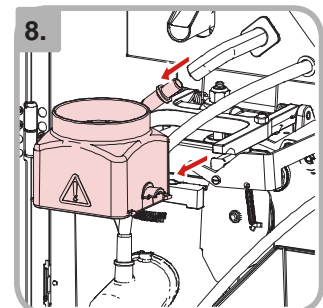

- Teile Brühkammer demontieren und reinigen

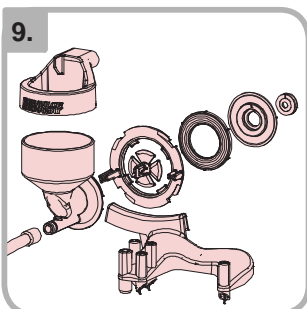

- Teile Mischgehäuse demontieren und reinigen

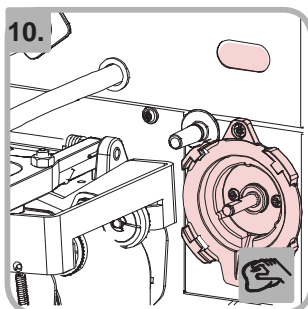

- Achse, Platte und Absaug-Öffnung reinigen

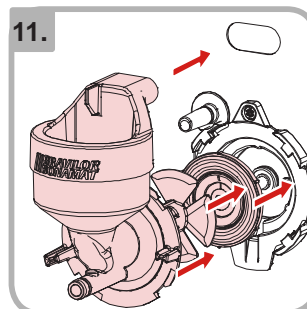

- Teile Mischgehäuse montieren

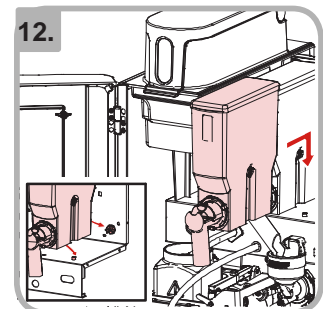

- Behälter zurückstellen

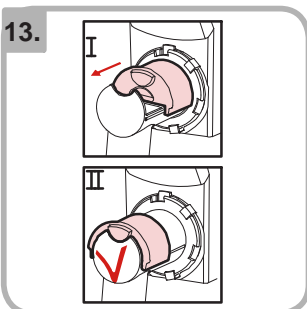

- Behälterauslauf öffnen

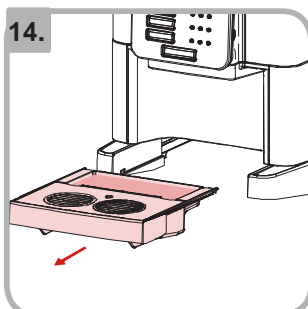

- Tropfblech entfernen

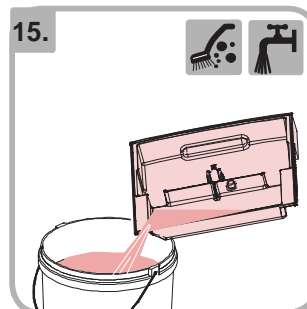

- Tropfblech leeren und reinigen



- Spülprogramm ausführen

Wöchentlich

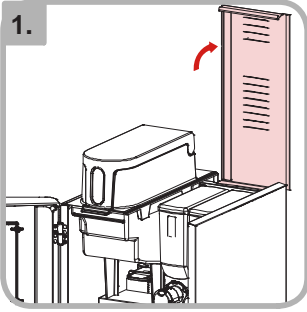

1. Tür und Deckel öffnen

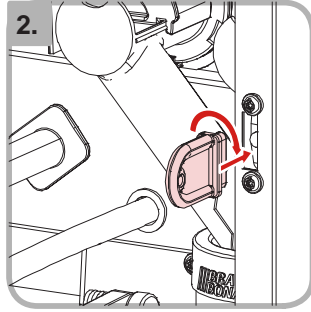

2. Kundendienstschlüssel

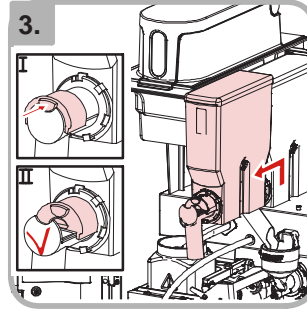

3. Behälterauslauf schließen und Behälter entfernen

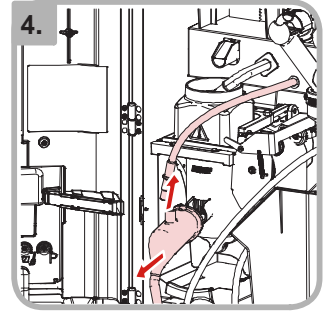

4. Schläge entfernen

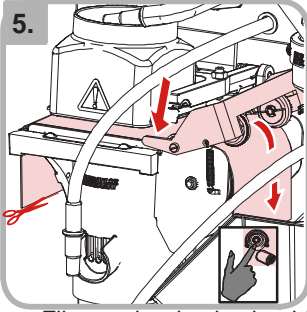

5. Filterpapier durchschneiden und entfernen (Taste Öffnen/Schließen)

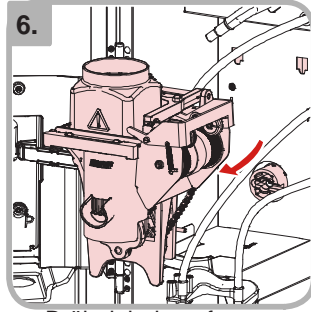

6. Brüheinheit entfernen

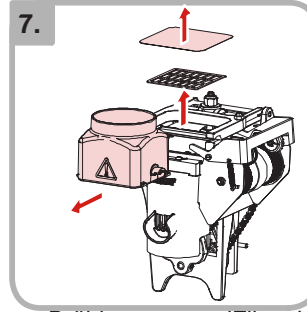

7. Brühkammer und Filtersieb entfernen

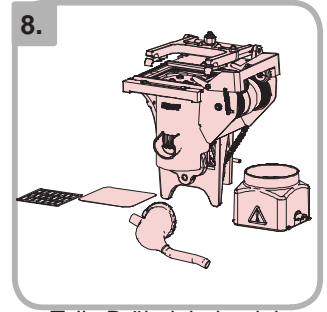

8. Teile Brüheinheit reinigen

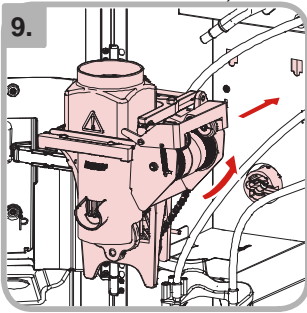

9. Behälter montieren

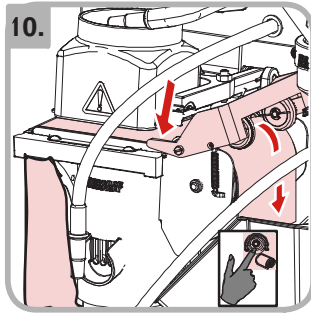

10. Filterpapier anbringen (Taste Öffnen/Schließen)

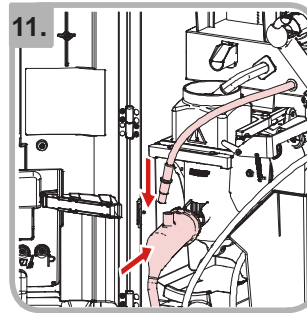

11. Schläge montieren

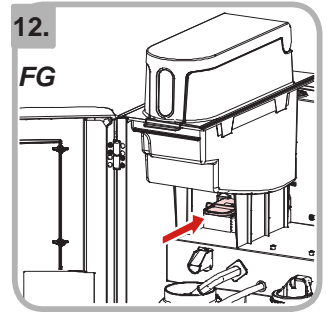

12. Behälterauslauf schließen

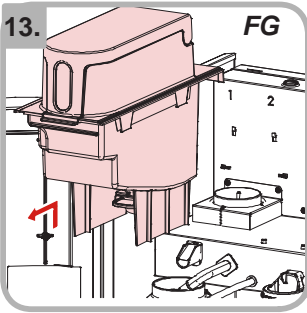

13. Kaffeebehälter entfernen

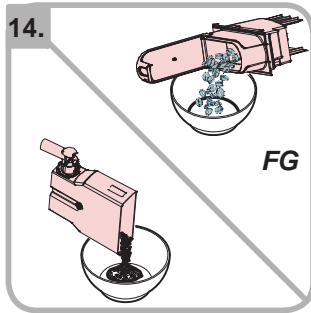

14. Behälter leeren

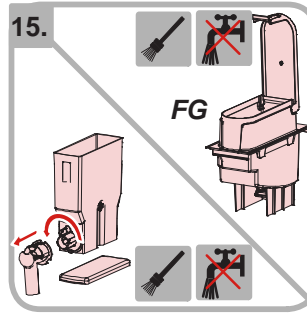

15. Behälter reinigen

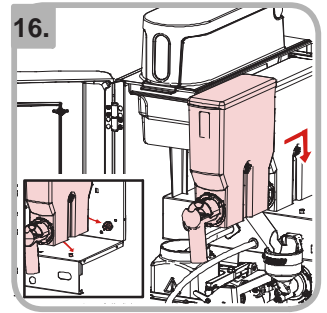

16. Behälter zurückstellen

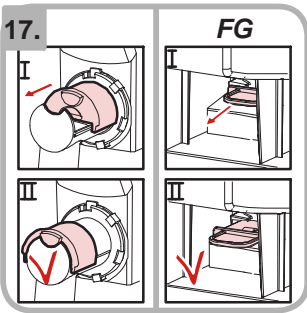

17. Behälterauslauf öffnen

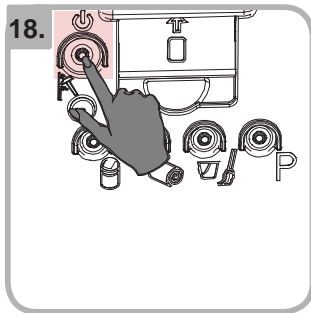

18. Maschine ausschalten

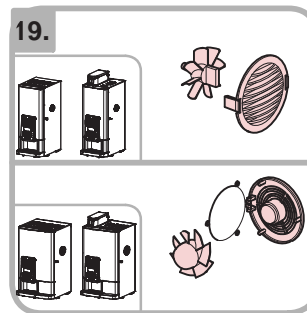

19. Ventilator Gitter und Rotor reinigen



20. Spülprogramm ausführen

Drei Mal am Tag*

1. 2. 3. 4.